



VA4220ZB VA4221ZB

Installation Guide

Smart Water Valve

sinopé

zigbee 3.0

1

Initiate the connectivity session by pressing the RF signal button  on the GT130 gateway. The indicator light will start flashing.

Compatible Zigbee gateway: refer to the installation guide for the latter.

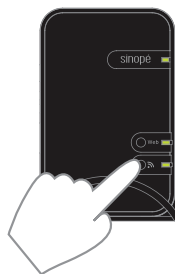

2

Remove the valve cover by unscrewing the 4 screws with a flat screwdriver.

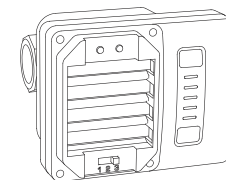

3

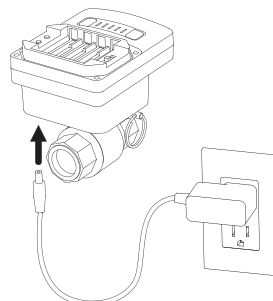

Connect the valve to an electrical outlet, using the supplied adapter, near where it will be installed. By doing so, you will validate the range of the Wi-Fi communication between the valve and your network.

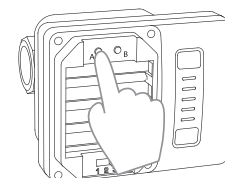

4

Press the "A" button to associate the valve with the Zigbee network.



Valve light 	Status
Green light blinks	Device is connecting
3 green lights lit for 5 s 	Successful connection
Red indicator light ON for 5 sec.	Connection has failed*

**Refer to the "Support" section of our Website at www.sinopetech.com.

WARNING

Although each unit is pre-tested at the factory, it is strongly recommended that you test the valve before installation to ensure proper operation in your home.

INSTALLATION OF THE SMART WATER VALVE

1

Make sure the valve is in the "OPEN" position before proceeding with the installation. Separate the controller from the ball valve:
A) Remove the pin
B) Tilt the controller back and slide it backwards

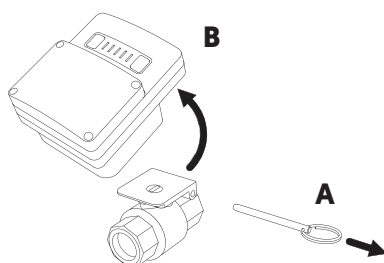

2

Close the main water supply. Open the hot and cold faucets near the main water supply to reduce the water pressure.

Remove the valve safety caps.

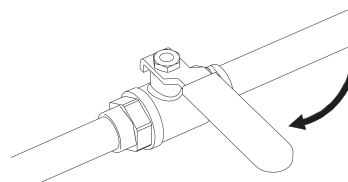

3

Install the smart water valve just downstream of the main water shut-off valve. Depending on your plumbing, additional fittings may be required (not included).

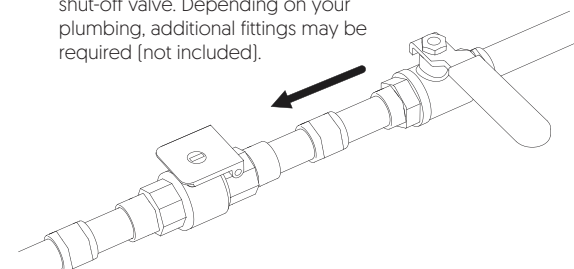

IMPORTANT: Be sure to leave sufficient space for the controller and the insertion of the pin.

4

Before replacing the controller, make sure that both the valve and controller are in the "OPEN" position.

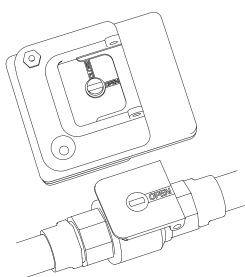

5

Put the controller back in place and insert the pin to secure the controller to the valve.

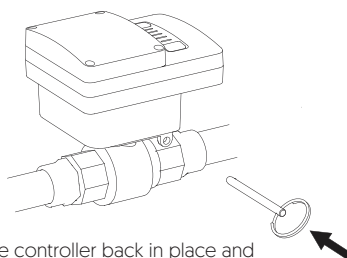

6

Power the valve using the AC adapter. To add an emergency power supply in the event of a power failure, insert 4 AAA lithium batteries (not included).

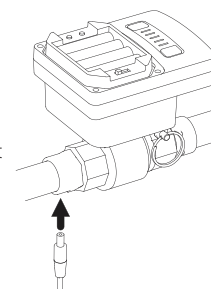

IMPORTANT: Do not insert the batteries before the valve is installed to your main water supply and powered by the supplied adapter.

7

Open the main water supply to make sure there are no leaks.

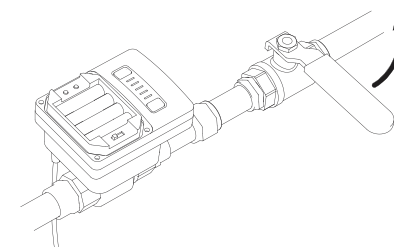

CONNECT YOUR SECONDARY VALVE TO THE MAIN VALVE

The Zigbee valve (VA4220ZB / VA4221ZB) can also act as a secondary valve to the main valve (VA4220WF / VA4221WF) to shut off a second water inlet when leaks are detected.

Once the secondary valve has been added to the main valve, the two valves will always have the same status (OPEN / CLOSE), regardless of whether the command comes from the main or secondary valve.

1

Remove the valve covers by unscrewing the 4 screws with a flat screwdriver.

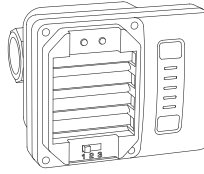

2

Connect both valves to a power outlet, using the supplied adapters, near the location where they will be installed. By doing so, you will validate the range of communication between the two valves.

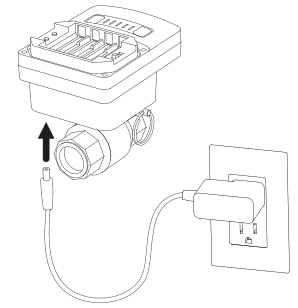

3

Press the "B" button on the main valve to open the network connectivity session. The indicator lights will light up in sequence to indicate that the session is active.

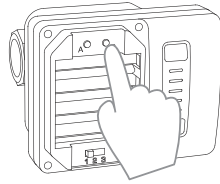

Main valve
VA4220WF / VA4221WF

Press the "A" button on the secondary valve to connect to the main valve.

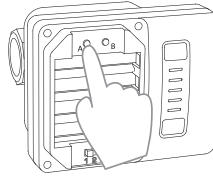

Secondary valve
VA4220ZB / VA4221ZB

4

Once the connection is established, press the "B" button on the main valve to close the connectivity session.

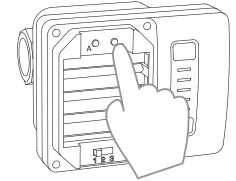

The connection between the 2 valves can be verified by closing the main valve. The secondary valve will then close automatically.

Valve light	Status
Green light blinks	Device is connecting
3 green lights lit for 5 s	Successful connection
Red indicator light ON for 5 sec.	Connection has failed*

TECHNICAL SPECIFICATIONS

Smart water valve

Ambient temperature: 1 °C to 40 °C [34 °F to 104 °F]

Maximum water temperature: 85 °C [185 °F]

Storage: -20 °C to 50 °C [-4 °F to 122 °F]

Valve body: stainless steel

Controller base: fiberglass reinforced

Maximum pressure: 145 PSI

Maximum torque: 2.5 N.m

Power supply: 5 V / 5 W [included]

Emergency power supply: 4 AAA lithium batteries [not included]

Certifications:

Conforms to CSA B125.3-12 Plumbing fittings

Valve body tested EU RoHS 2 [Directive 2011/65/EU]

Diameter

VA4220ZB: ¾ in NPT x ¾ in NPT

VA4221ZB: 1 in NPT x 1 in NPT

Zigbee 3.0 profile

Frequency: 2.4 GHz

Transmission power: +20 dBm

Receiver sensitivity: -108 dBm

Indoor installation only.

Transmitter module IC: 22394-ZBMIS01/ FCC ID: 2AK2T-ZBM1501

This device complies with Industry Canada license exempt RSS standard(s). Operation is subject to the following two conditions:

(1) this device does not cause interference, and (2) this device must accept any interference, including interference that may cause undesired operation of the device.

This equipment has been tested and found to comply with the limits for a Class B digital device, pursuant to part 15 of the FCC Rules. These limits are designed to provide reasonable protection against harmful interference in a residential installation. This equipment generates, uses and can radiate radio frequency energy, and if not installed and used in accordance with the instructions, may cause harmful interference to radio communications. However, there is no guarantee that interference will not occur in a particular installation. If this equipment does cause harmful interference to radio or television reception, which can be determined by turning the equipment OFF and ON, the user is encouraged to try to correct the interference by one or more of the following measures:

Reorient or relocate the receiving antenna.

Increase the separation between the equipment and receiver.

Connect the equipment into an outlet on a circuit different from that to which the receiver is connected.

Consult the dealer or an experienced radio/TV technician for help.

3-year limited warranty

SINOPÉ TECHNOLOGIES INC. warrants the components of their products against defects in material and workmanship for a 3-year period from the date of purchase, under normal use and service, when proof of purchase of such is provided to the manufacturer. If at any time during the warranty period the product is determined to be defective, SINOPÉ TECHNOLOGIES INC. will replace it. This warranty does not cover any transportation costs that may be incurred by the consumer. Nor does it cover a product that has been improperly installed, misused or accidentally damaged. A water detector's casing that has completely been immersed in water will not be covered by the warranty. The obligation of SINOPÉ TECHNOLOGIES INC., under the terms of this warranty, will be to supply a new unit and this releases the manufacturer from paying the installation costs or other secondary charges linked to replacing the unit or the components. The manufacturer shall not be liable for incidental, consequential, or special damages arising at, or in connection with product use or performance. This warranty does not cover damages or loss caused by defects, and the owner's use of the SINOPÉ TECHNOLOGIES INC. product confirms the understanding that this product does not constitute an insurance policy, and is only a product used to reduce the risk of water damage.

sinopé

For more information, visit our Website:

www.sinopetech.com

