

# Installation guide

SW2500ZB-C4

Smart Light Switch

zigbee 3.0



sinopé

## Your SW2500ZB-C4 light switch

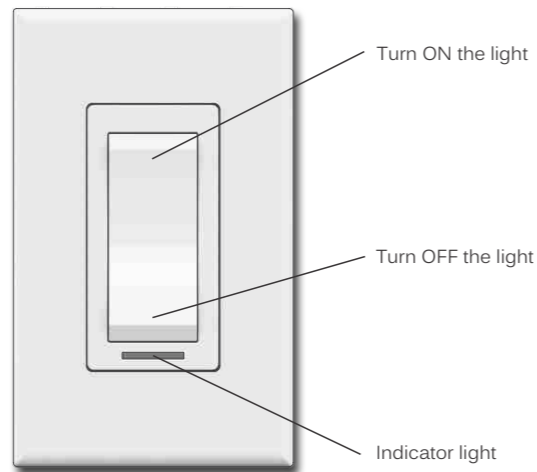

Light turned ON = Blue  
Light turned OFF = Amber

The indicator intensity can be changed from your Control4 controller.

## Warnings

This product is only compatible with the Control4 home automation system.

The installation of this light switch should be made by a certified electrician and must be installed in conformity with the national and local Electrical Codes.

This light switch requires a neutral wire. If your electrical box does not have a neutral wire, you can either add one or install the light switch at a different location.

## Technical specifications

Operating voltage	120 Vac, 60 Hz
Operation temp.	0 °C to 40 °C (32 °F to 104 °F)
Storage	-20 °C to 50 °C (-4 °F to 122 °F)
Standard UL	Conforms to ANSI/UL Std. 916
Standard CSA	Certified to CAN/CSA Std. C22.2 No205

## Maximum load:

450 W: LED, CFL, Halogen

600 W: Incandescent

1800 W: Resistive

1/2 HP: Ceiling fan

## Zigbee 3.0 profile

Frequency: 2.4 GHz

Transmission power: +20 dBm

Receiver sensitivity: -108 dBm

## Install your light switch

- 1 Make sure that the breaker for your switch is OFF at the main electrical panel then remove the old switch.

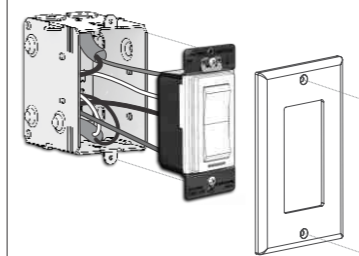
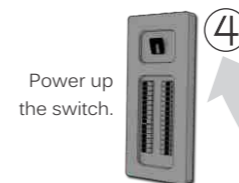
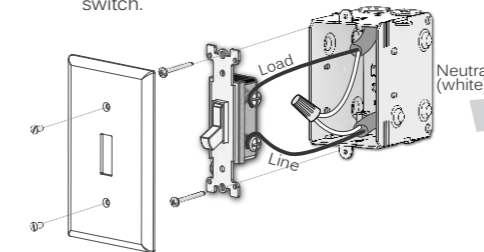

Use the provided screws to secure the light switch to the electrical box. Then, replace the wall plate.

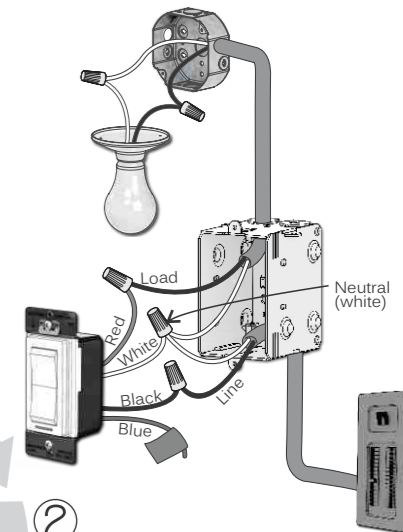

Use the provided connectors to connect the wires as follows:

Red	→	Load
Black	→	Line
White	→	Neutral
Blue	→	None*

\*Note: For a single pole installation, do not remove the label on the blue wire.  
For a 3-way installation, consult the 3-way wiring diagram on the next page.



Make sure to firmly tighten the wire connectors for a secure connection. A loose connection can be a fire hazard. Special CO/ALR solderless connectors must be used when connecting with aluminum conductors.

### Single pole wiring diagram

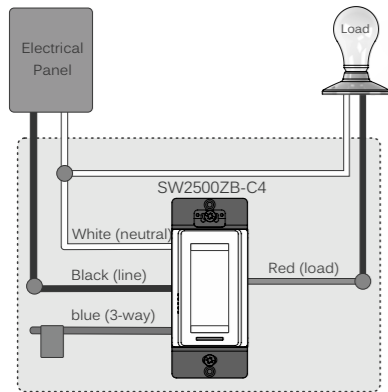

### 3-way wiring diagram

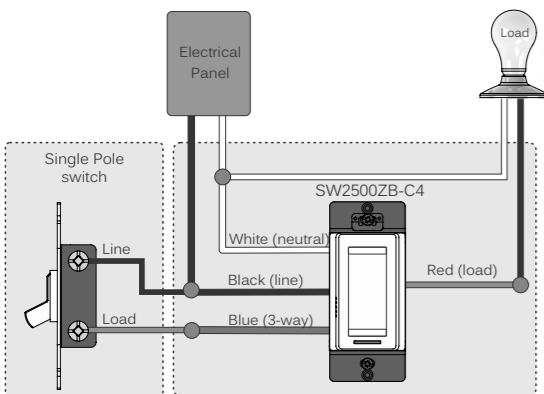

### Connect your light switch to a Control4 home automation system

1

Initiate the Control4 controller connectivity session by referring to it's user guide.



2

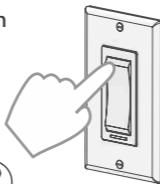

Connect your light switch to the network by pressing the top button 4 times.

On the switch: The indicator flashes blue when the device is connecting.

**The indicator turns red = Failed**  
Refer to the "support" section of our Website to troubleshoot the unit.

**The indicator turns green = Connected**

After a few seconds, the indicator changes color depending on the switch status.  
(Turned ON = blue, Turned OFF = amber)

4

When all the light switches are connected, close the connectivity session of the Control4 controller.



3

Connect all your switches the same way, by going to the next closest switch.



For more information, visit our website at: [www.sinopetech.com](http://www.sinopetech.com)

### Disconnect your light switch from a Control4 home automation system

To disconnect your light switch from a Control4 controller, press the 2 buttons of the light switch simultaneously for 10 seconds.

This action will also restore the factory settings of your light switch. All your settings will be deleted.

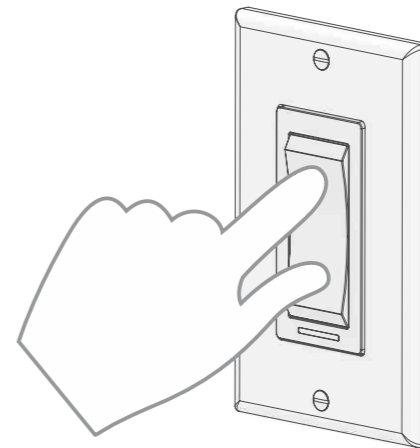

Transmitter Module IC: 22394-ZBM1501 / FCC ID:2AK2T-ZBM1501

This device complies with Industry Canada license exempt RSS standard(s). Operation is subject to the following two conditions:  
(1) this device does not cause interference, and (2) this device must accept any interference, including interference that may cause undesired operation of the device.

This equipment has been tested and found to comply with the limits for a Class B digital device, pursuant to part 15 of the FCC Rules. These limits are designed to provide reasonable protection against harmful interference in a residential installation. This equipment generates, uses and can radiate radio frequency energy, and if not installed and used in accordance with the instructions, may cause harmful interference to radio communications. However, there is no guarantee that interference will not occur in a particular installation. If this equipment does cause harmful interference to radio or television reception, which can be determined by turning the equipment OFF and ON, the user is encouraged to try to correct the interference by one or more of the following measures:

- Reorient or relocate the receiving antenna.
- Increase the separation between the equipment and receiver.
- Connect the equipment into an outlet on a circuit different from that to which the receiver is connected.
- Consult the dealer or an experienced radio/TV technician for help.

### 3-year limited warranty

SINOPÉ TECHNOLOGIES INC. warrants the components of their products against defects in material and workmanship for a 3 year period from the date of purchase, under normal use and service, when proof of purchase of such is provided to the manufacturer. This warranty does not cover any transportation costs that may be incurred by the consumer. Nor does it cover a product that has been improperly installed, misused or accidentally damaged. The obligation of Sinopé Technologies Inc., under the terms of this warranty, will be to supply a new unit and this releases the manufacturer from paying the installation costs or other secondary charges linked to replacing the unit or the components.

**sinopé**

For more information, visit our Website:

[www.sinopetech.com](http://www.sinopetech.com)

To be informed about our upcoming products:



or subscribe to our newsletter.