

# sinopé

## TR1310

### Installation Guide

Expansion unit for floor heating thermostat

#### Warnings

The installation of this thermostat must be performed by a certified electrician and comply with the national and local electrical codes and regulations.

Before starting the installation of your new thermostat, please make sure that the breakers for your heating system are off at the main electrical panel!

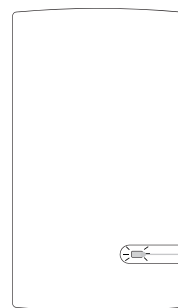

The expansion unit is designed to increase the maximum load permitted by the thermostat. The thermostat will be able to control multiple sections of floor heating that will be operated by one or more expansion units.

Load status

#### TECHNICAL SPECIFICATIONS

##### Operating voltage:

120/208/240 Vac, 50/60 Hz

##### Maximum load:

1800 W @ 120 V / 15 A  
3120 W @ 208 V / 15 A  
3600 W @ 240 V / 15 A

Resistive load only

##### Storage:

-20 °C à 50 °C [-4 °F à 122 °F]

#### INSTALL YOUR EXPANSION UNIT

- 1 Unlock and lift the unit cover.

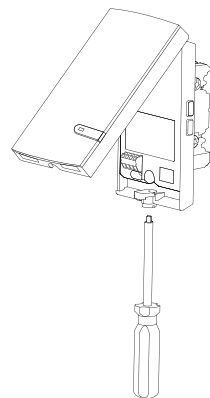

- 2 Connect the cables in the junction box to the terminals of the unit.

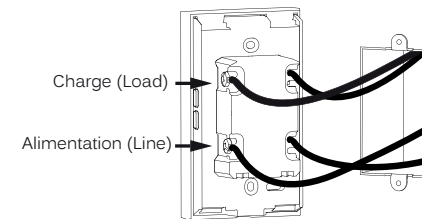

Make sure to firmly tighten the screw terminals for a secure connection. A loose connection can be a fire hazard.

- 3 Use the two screws to secure the unit to the electrical box.

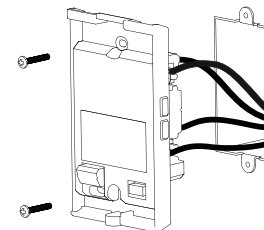

- 4 Connect the wires [20 to 24 AWG] to the expansion units. The wires are not polarized.

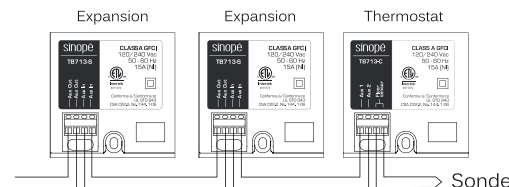

- 5 Replace the cover and lock. Power up the unit.

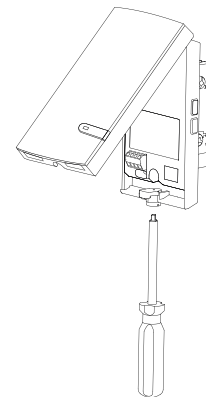

To avoid damaging your floor, make sure that the adhesive is cured before starting the heating.

#### TESTING THE GROUND FAULT PROTECTION

The expansion unit is equipped with automatic verification of ground fault circuit interrupter [GFCI].

##### You can also do this manually:

1) Press the TEST button. If the RESET button's red warning light does not turn ON, the test has failed. Cut the power to the heating system from the main electrical panel and ask a qualified electrician to verify the installation.

2) Press the RESET button to restart the expansion module's base.

Repeat these steps for all expansion units.

It is recommended to test the GFCI monthly to ensure proper operation of protection against leakage.

#### 3-year limited warranty

SINOPE TECHNOLOGIES INC. warrants the components of their products against defects in material and workmanship for a 3-year period from the date of purchase, under normal use and service, when proof of purchase of such is provided to the manufacturer. This warranty does not cover any transportation costs that may be incurred by the consumer. Nor does it cover a product subjected to misuse or accidental damage. The obligation of SINOPE TECHNOLOGIES INC., under the terms of this warranty, will be to supply a new unit and this releases the manufacturer from paying the installation costs or other secondary charges linked to replacing the unit or the components.

sinopé

For more information, visit our Website:

[www.sinopetech.com](http://www.sinopetech.com)

660-0722-0000-D

